

PTI INTEGRATED SYSTEMS PROPRIETARY
THIS DOCUMENT AND THE INFORMATION DISCLOSED HEREIN ARE
PROPRIETARY DATA OF PTI INTEGRATED SYSTEMS. NEITHER THIS
DOCUMENT NOR THE INFORMATION CONTAINED HEREIN SHALL BE
REPRODUCED, USED OR DISCLOSED TO OTHERS WITHOUT THE
WRITTEN AUTHORIZATION OF PTI INTEGRATED SYSTEMS.

PT REV	DESCRIPTION	BY	DATE
-	RELEASED.	LAC	9/23/04

NOTE: RELAY 1 SHOWN
FOR REFERENCE.

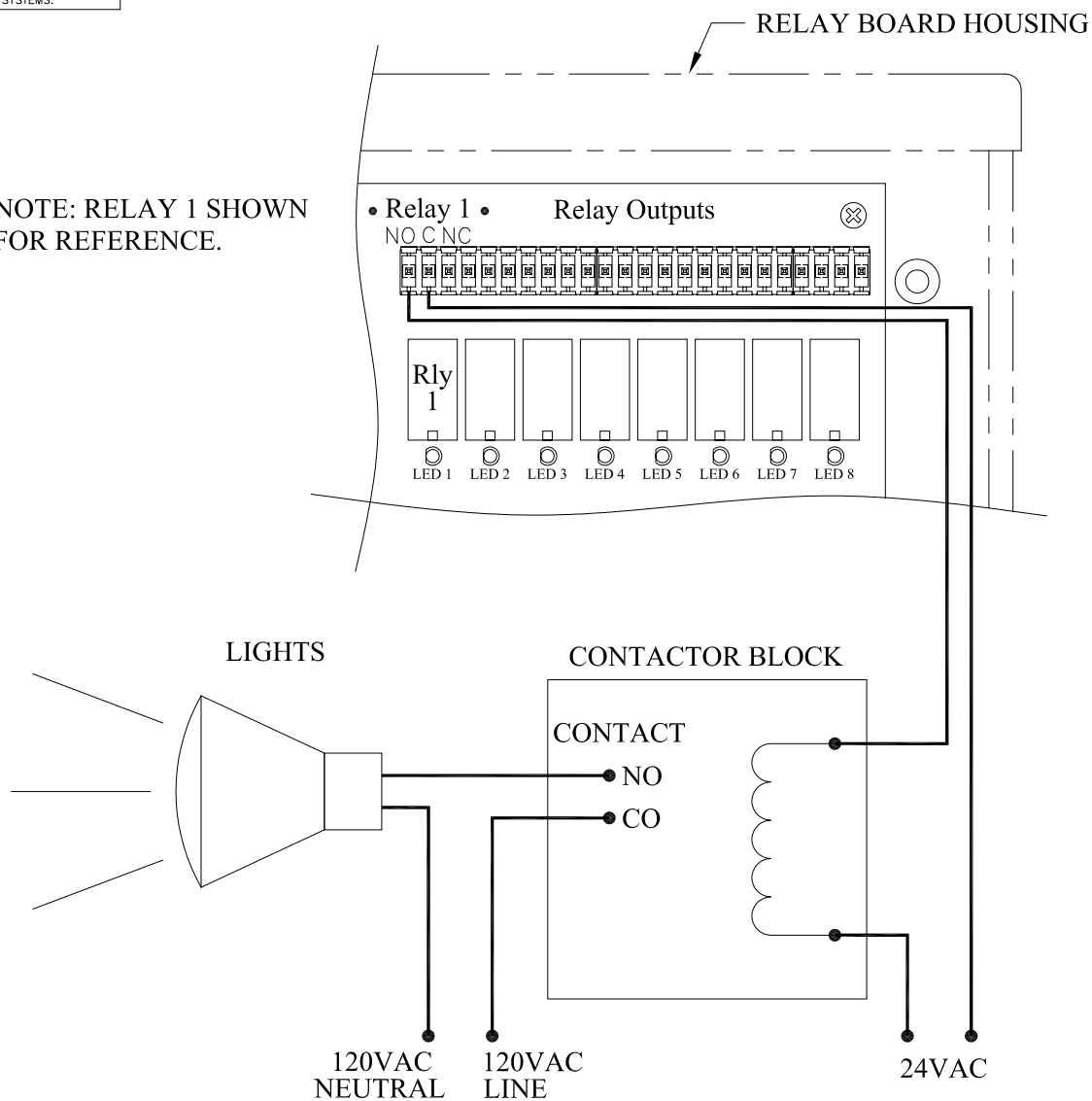

THIRD ANGLE PROJECTION

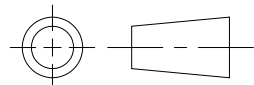

UNLESS OTHERWISE SPECIFIED

ALL DIMENSIONS IN INCHES.

TOLERANCE: \pm N/A

ANGLE TOLERANCE (DEG): \pm N/A

REMOVE BURRS & SHARP EDGES.



8271 E. Gelding Drive
Scottsdale, AZ 85260
Phone 480.991.1259
FAX 480.991.1395

ORIG. DATE 9/23/04

DRAWING DESCRIPTION

8 CHANNEL RELAY BOARD,
LIGHTING CONTROL CIRCUIT
WIRING DIAGRAM

SIZE	SCALE	DWG NO.	DWG REV
A	NONE		- .00

DRAWN BY L. CAMPANELLI

SHEET 1 OF 1