

Magravs Car Unit

Hybrid Plasma Energy Unit

Features/Installation/Instructions/Warranty



WARNING

- No one should use this device before reading carefully all the instructions contained in this manual, which must be kept in a safe place for future use.
- **Use this device in the manner intended by the manufacturer, and in accordance to the instructions contained in this manual, with caution and care.**
- Improper use of the device can lead to personal injury and material damage.
- **Do not expose device to the elements.**
- The safe use of this device depends on the observance of the safety precautions and on careful reading and understanding of this manual.

SAFETY INSTRUCTIONS; RISK OF ELECTRIC SHOCK AND FIRE.

1) Read carefully all the instructions before using the device. Do not allow people who have not read and understood the manual of instructions to operate the device. In the event that the device is handed over to a third party, a copy of this manual must also be handed over together with the device. This device must not be used by children or the infirm.

2) Remove the device from the box carefully and inspect for damage.

3) Before connecting the Magravs Car Unit, ensure your vehicle conforms to the requirements of this manual.

4) Do not connect the device to damaged or substandard wiring. If the wiring becomes damaged, consult a qualified technician to repair the wiring.

5) The electric cords must be intact. Do not operate any device with a damaged cord or if the device malfunctions, has been damaged in any manner. No user serviceable parts inside the Magravs Car Unit. If required, return the device to authorized service facility for examination, electrical or mechanical adjustment, or repair. The electric cord must not be pulled, twisted, crushed or knotted.

6) Do not move the device by pulling the electric cords. The electric cords, as well as the entire device must be kept dry. Do not immerse the device in water or other liquids. Protect it against moisture. Do not place the electric cords in contact with hot surfaces or heat.

7) Do not cover the device while in use: RISK OF FIRE. Keep away from flammable objects.

8) This device must be kept dry and away from sources of moisture. Do not expose to bad weather. Do not immerse the device in water. Should the device get wet, disconnect the Magravs Car Unit and contact your supplier. Use of this device is not recommended in spaces with high levels of moisture.

9) Keep away from direct heat source or direct sunlight. Keep away from open flames. Do not place near flammable materials.

10) Do not turn upside down. Mount the device on a stable and secure location. Do not mount the device on soft surfaces or on unstable bases. Do not move the device while it is in use.

11) This device is not intended for industrial use. Any other use is considered inappropriate and therefore dangerous.

12) In case of overheating, wait for it to completely cool down. Should the problem occur again, remove the Magravs Car Unit and consult a qualified technician before using the device again.

13) In case you experience any abnormal situation, strong odor, or other problems, remove it from the vehicle and consult a qualified technician.

14) Before cleaning the device or carrying out any checks, disconnect the device from the battery. Do not use any spray products or harsh chemicals directly on the device. Clean with a soft, lightly moist cloth and ensure the Magravs Car Unit is dry before resuming operation.

15) Do not insert or allow foreign objects to enter the Magravs Unit.

Do not move the device while it is in use.

16) This device must not be dismantled and no change must be made to its structure and function mechanism. Any change can be dangerous and cause electric shock.

Internal parts cannot be replaced by user.

17) Do not handle or use the device with wet hands.

Do not use under poor safety conditions.

18) Do not tamper with the device. Do not use for purposes other than those indicated.

Any misuse, unreasonable use, or use contrary to what is specified in this manual can be risky.

19) The plastic bag, carton, staples and other packaging materials may be dangerous to children. Dispose of the packaging properly.

20) For use with boats, extra precautions are required to ensure a dry mounting and operating location.

21) The electrical connections must be carried out by a qualified technician in accordance with international standards IEC6034-1.

22) Do not use this appliance while it is raining or in in wet environments. Do not expose to bad weather. Do not immerse the appliance in water. Protect against splashes. Do not use with bare or wet hands. Do not use this appliance near washbasins, sinks, swimming pools, saunas, water containers, or other liquid containers. Do not wet the appliance. This appliance must remain dry. Do not wet the cords.

In case liquids accidentally come into contact with parts of the appliance or cords, immediately discontinue the use. Before using the appliance again, make sure it is completely dry.

23) The producer will not be considered responsible for damages caused, both to the user and to the third party, in case of incorrect handling or wrong use and/or different use from what is explained in this operating manual. The use of non-original accessories might cause damages to third parties or to the user and compromise the functions of the appliance. The use of the appliance with non-original accessories or accessories not correctly assembled invalidates the warranty of the product.

An incorrect and inaccurate use may damage the appliance and cause damage to the user. Do not hold and lift the appliance by the cords. Never twist, kink or wrap the cord around the appliance as this may cause the cord insulation to weaken and split, particularly where it enters the unit. Protect the appliance's electric cords from getting in contact with sharp rough edges. Absolutely do not use the appliance if: it is damaged; the cords are damaged; it has fallen; it is wet; it fell in water (even if it has dried).

In these cases it is necessary to contact an authorized assistance point centre for a check-up, and if necessary, have it repaired. The appliance should not get in touch with real flames or sources of heat. Do not use the appliance to damage objects or to offend people and animals.

24) Use in Vertical Position only.

25) Avoid using the appliance in presence of solvents, in a corrosive and explosive atmosphere, in presence of dust or sawdust: risk of fire and explosion.

Should the appliance show malfunctioning or abnormalities at the first use, switch it off immediately and contact an authorized assistance point centre.

Your Magrav Unit, a New Paradigm in Energy

Copper wires have been used to transmit electricity via electron vibration. This is the old, outdated paradigm, which relies on a very small spectrum of what exists in nature.

Now, with magnetical-gravitational (MaGravs) technology, power is released and transmitted via the nano-coating of copper. The nano layers absorb ambient plasma energy and release usable plasma, which is much more powerful than simple electron vibration.

Plasma is found everywhere around us - in the air, our bodies, around the planet and in outer space. Through the nano layers, this boundless energy is then converted to usable energy which can power our devices.

Just like bringing home a new puppy, we need to allow the Magravs Car Unit to NANO-COAT the car's wiring and body to add another source of energy to your car. This energy is the raw energy of Creation, and can be harnessed to induce and assist the motion in your car's engine and drivetrain. The complete list of positive effects of Magravs plasma is so long that it is not possible to list them all here. Although it may appear to be plug and play, **it is actually plug and interplay - you are one part of the whole connection!**

It is time for Humanity to reconnect with the energetic plasma world!

Once installed, the Magravs Car Unit will nano-coat all wires and the body of the car in a gradual and systematic manner.



It is important to remember that the Magravs Car Unit should remain connected to the car continuously in order for it to work effectively.

Please read all the instructions below before connecting your Magravs Car Unit to your vehicle. Failure to follow instructions may cause the unit to be rendered inoperative and therefore fall outside the scope of manufacturer's warranty.

What You Need To Know

Installation of the Magravs Car Unit is simple:

- there are no hard and fast rules, only guidelines
- every installation is different and you get to decide what's optimal for your car
- the point of the Magravs Car Unit is to allow plasma energy to act on the wiring and the body of your car
- do not solder any wire connections; only use twist connections or by crimping
- keep the Unit inside the vehicle where it is protected from direct exposure to the elements
- keep the Unit firmly secured inside the vehicle to avoid damage from impact and vibration
- avoid sharp metal edges when routing wires; use rubber grommets if the wiring needs to be routed through metal firewalls/bulkheads
- you may choose to install a 10A automotive fuse in-line for safety, although we have found in testing that fuses are not necessary.

Effects of Plasma on the car

Unlike the Magravs Car Unit for homes, the Car Unit does not require deliberate conditioning. This is because vehicles operate on DC and plasma is by itself DC in nature.

However, time will be required for the Unit to settle into its environment and start flowing plasma through the wiring and bodywork of your car.

This depends on how often and for how long your car is driven each time, since this is where the greatest flow of electricity is normally seen through the vehicle. Plasma will take this behaviour and mimic it. Therefore, the Unit will flow the greatest amount of plasma through your vehicle during its operation as compared to when it is sitting parked.

Limited effects will be almost immediate. This includes the smoother idling and running of the engine. You may also notice a greater feeling of well-being when in your vehicle.

Greater effects will become noticeable over time. This includes better fuel economy and more power and torque from the engine. The vehicle may also feel positively different to drive, in that it stops, turns and goes much more effectively than before. The idea is to channel plasma through the rotating components of the car such as engine, transmission and driveshafts, to allow the plasma to assist in the motive aspect of these components.

Remember, plasma is not electricity, and can be anything including rotational motive force. Think of how planet Earth spins.

Installation - Petrol, Diesel & Hybrid Vehicles

Option 1

The simplest way to install the Magravs Car Unit is to:

- 1 - connect the positive (+) lead of the Unit to the positive (+) battery terminal of the vehicle.
- 2 - connect the negative (-) lead of the Unit to a solid grounding point on the other end of the vehicle.

NOTE: THE TWO CONNECTIONS SHOULD BE AS FAR APART AS PRACTICABLE.

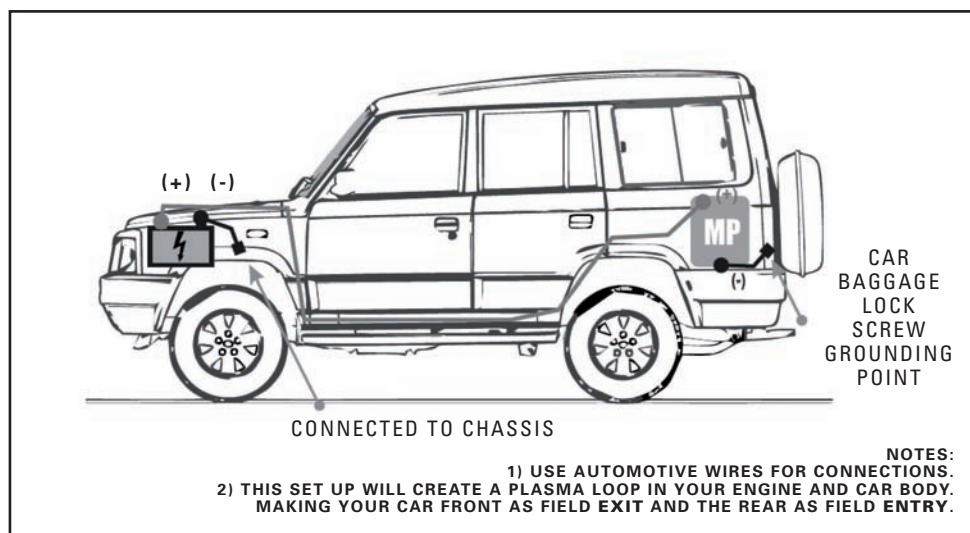

Option 2

The most efficient way to allow plasma to flow in your vehicle is to create specific pathways from the Magravs Car Unit to the various components which will benefit directly from plasma.

Therefore we suggest creating direct pathways to the:

- 1 - Chassis grounding point
- 2 - Starter motor ground connection
- 3 - Intake manifold or engine block grounding point

The connection from the Magravs Car Unit to the chassis grounding point is the same as Option 1. Then we add the other connections to create a plasma field loop in your vehicle. An additional cable will be required for the negative (-) lead in this type of connection. This additional cable is not included in the package.

We suggest if you are not confident in this installation, you consult a professional such as a car stereo installer.

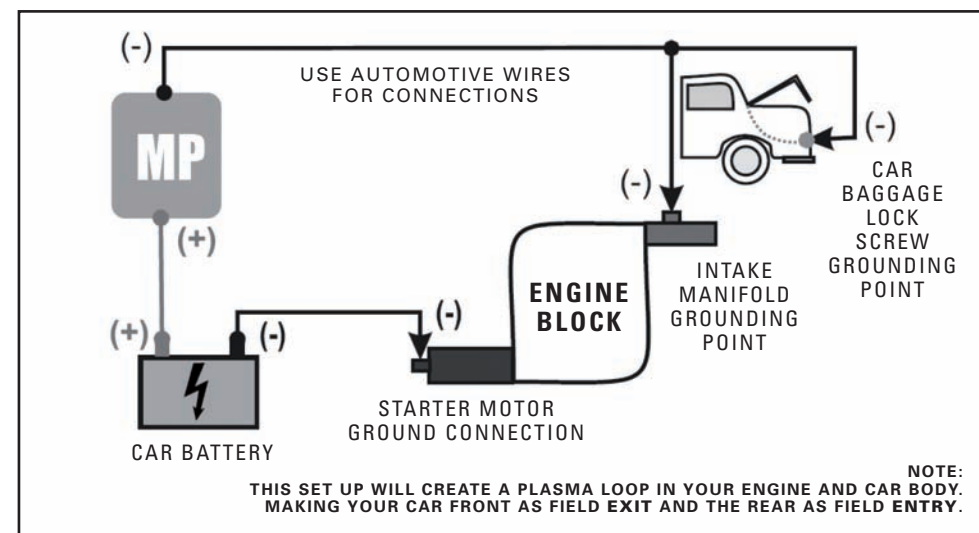

Frequently Asked Technical Questions

Q: HOW SOON WILL I FEEL THE POSITIVE EFFECTS OF THE MAGRAVS CAR UNIT ON MY VEHICLE?

A: It varies from vehicle to vehicle. Although plasma can flow when the vehicle is turned off and parked, this flow will be minimal since that is how vehicles are designed to prevent draining the battery. As a general rule of thumb, the more often a vehicle is driven and the longer the duration of each journey, the greater the flow of plasma and therefore the quicker the nano-coating process.

Q: APART FROM IMPROVED FUEL ECONOMY, WHAT OTHER POSITIVE EFFECTS CAN I LOOK FORWARD TO?

A: One of the first effects that most people notice is that their vehicle's engine runs smoother and idles more cleanly. Others have noted more power during acceleration, the vehicle being easier to turn, brake and accelerate, an enhanced feeling of well-being as well as a feeling of weighing less while in the car, to name a few.

Q: WHY ISN'T THERE A CONDITIONING PHASE FOR THE MAGRAVS CAR UNIT WHEN SUCH A PROCEDURE IS REQUIRED FOR THE MAGRAVS HOME UNIT?

A: In a home application, plasma has to mimic alternating current (AC) to drive appliances. In a vehicle, plasma has to simply be itself in its direct current (DC) state to add an additional source of energy to the vehicle. However, nano-coating will still happen gradually, and positive effects will be seen progressively, as with the Magravs Home Unit.

Q: WHY ISN'T THERE A CONNECTION OPTION FOR PURE ELECTRIC VEHICLES?

A: have found that the AC inverter of the motor interferes with the proper operation of the Unit. Please standby for announcements on our webpage.

Dear Customer,

thank you for buying the Magravs Car Unit (hereon described as "the Unit").

Please be informed that, for warranty claims, you can send the Unit to us. In the event of a legitimate claim, we will repair and return the Unit to you.

Please be advised that you are responsible for shipping costs incurred in returning the Unit to us.

Before sending the Unit, please contact our service center at support.keshfoundation.org specifying:

- ORDER NUMBER;
- PRODUCT NAME;
- DATE OF PURCHASE;
- DESCRIPTION OF DEFECT REPORTED;
- ADDRESS AND TELEPHONE NUMBER.

We will then contact you to help resolve the issue.

Notes for delivery

Package the faulty appliance carefully and include the following information:

- ORDER NUMBER;
- PRODUCT NAME;
- DATE OF PURCHASE;
- DESCRIPTION OF DEFECT;
- ADDRESS AND TELEPHONE NUMBER;
- PRINTOUT OF YOUR E-MAIL;
- ATTACH A COPY OF THE RECEIPT OR INVOICE FOR PROOF OF VALIDITY.

Plasma Products Warranty

1) GENERAL RULES

This warranty is intended as an addition to all other rights enjoyed by the product purchaser/customer. It does not replace these rights and, specifically, in no way affects the customer's rights as established by European law.

2) WARRANTY DURATION AND VALIDITY

The device is guaranteed by Keshe Foundation for a period of 24 months from date of purchase. This date must be proven by: invoice or receipt bearing date of sale, details identifying the appliance, type, model.

Failure to produce the stated documents will invalidate the product warranty.

This warranty includes the free replacement or repair of the device's parts, should the authorized Service Centre find the unit to have defects in materials or workmanship.

3) EXCLUSIONS FROM WARRANTY/THIS WARRANTY EXCLUDES:

All damages arising as a result of negligent and/or careless use, repairs carried out by unauthorized staff, careless transport and improper installation.

4) LIMITS OF LIABILITY

Keshe Foundation declines all responsibility for any possible damage caused directly or indirectly to people or objects as a consequence of failure to comply with the provisions of the specific device "Instruction Manual" on blueprint.keshefoundation.org/manual.php

5) EXPIRY OF WARRANTY

Once the 24-month duration of this warranty has elapsed, all repairs will be at the customer's own expense.

INSTALLATION

Place on a stable, safe, flat base. Choose a location where it will not be a hindrance to the passage, and at least 50 cm away from any flammable objects.

DO NOT USE IN BATHROOMS. The power cable should always be monitorable.

CLEANING AND MAINTENANCE

This appliance does not need special cleaning or maintenance. To remove any dust, simply use a soft, dry cloth. **DO NOT USE LIQUIDS, DO NOT IMMERSE IN WATER, PROTECT AGAINST SPLASHES.**

This appliance must remain dry. Do not use bleaching agents and those containing chlorine; they may irreversibly damage its surface. Do not use solvents, chemicals, sprays, or abrasive or similar objects to clean of any of the appliance's parts since they may damage it irreversibly.

During long periods of disuse, keep the appliance in its original packaging and store it in a cool dry place, away from sources of heat.

DISPOSAL OF PACKAGING

Paper and carton of this appliance are recyclable. In any case do not deposit the package in the common garbage or scatter it in the environment. Packages must be disposed of through differentiated waste collection and disposal methods, separating them by typologies as per the rules in force in your country in order to facilitate the recycling process of raw materials.

Contact your Municipality or authorized garbage dump centre point for relevant and detailed information.

The law relating to the recycling of packaging for consumption goods through the National Packaging Consortium has been applied to this appliance.

WARNINGS AND GENERAL SAFETY RULES

Risk of electric shock. Do not open, dismantle or modify the appliance or parts of it. Inside the device there are dangerous tensions or high voltage electric current.

Do not dismantle, do not open, do not try to repair the appliance by yourself, not even after the warranty period.

INSTALLATION

Place on a stable, safe, flat base. Choose a location where it will not be a hindrance to the passage, and at least 50 cm away from any flammable objects.

CLEANING AND MAINTENANCE

This appliance does not need special cleaning or maintenance. To remove any dust, simply use a soft, dry cloth. **DO NOT USE LIQUIDS, DO NOT IMMERSE IN WATER, PROTECT AGAINST SPLASHES.**

This appliance must remain dry. DO NOT use bleaching agents and those containing chlorine; they may irreversibly damage its surface. Do not use solvents, chemicals, sprays, or abrasive or similar objects to clean of any of the appliance's parts since they may damage it irreversibly. During long periods of disuse, keep the appliance in its original packaging and store it in a cool dry place, away from sources of heat.

DISPOSAL OF PACKAGING

Paper and carton of this appliance are recyclable. In any case do not deposit the package in the common garbage or scatter it in the environment. Packages must be disposed of through differentiated waste collection and disposal methods, separating them by typologies as per the rules in force in your country in order to facilitate the recycling process of raw materials. Contact your Municipality or authorized garbage dump centre point for relevant and detailed information.

The law relating to the recycling of packaging for consumption goods through the National Packaging Consortium has been applied to this appliance.

WARNINGS AND GENERAL SAFETY RULES

Risk of electric shock. Do not open, dismantle or modify the appliance or parts of it. Inside the device there are dangerous tensions or high voltage electric current.

Do not dismantle, do not open, do not try to repair the appliance by yourself, not even after the warranty period.

WARRANTY

It is recommended to keep the purchasing document as an essential requirement to apply the warranty rules. The warranty does not cover damages caused to the appliance due to an improper use or different use from what's explained in this operating manual.

DISPOSAL OF WASTE ELECTRICAL AND ELECTRONIC EQUIPMENT (WEEE)



Shows that the product must be disposed of separately from other waste at the end of its lifecycle in accordance with the relevant local regulations for the environmentally safe disposal of systems and electronic components and cannot be disposed of as urban waste.

At the end of its working life, the product must be taken to a special local authority waste collection centre or to a dealer providing appliance recycling services, or to a retailer (in case you want to replace it by buying another equivalent appliance). The appliance meets the requirements of the Legislative Decree No 151/2005 and subsequent amendments on the Implementation of Directives 2002/95/EC, 2002/96/EC and 2003/108/EC, concerning the reduction of hazardous substances in electrical and electronic equipment, and disposal of waste.

Ask for information from the local authorities about urban waste disposal centres or locations. Whoever doesn't dispose of the appliance according to the applicable rules will be liable for fines.

IMPORTANT

The producer will not be considered responsible for damages caused, both to the user and to the third party, in case of incorrect handling or wrong use and/or different use from what is explained in this operating manual. The use of non-original accessories might cause damages to third parties or to the user and compromise the functions of the appliance.

The use of the appliance with non-original accessories or accessories not correctly assembled invalidates the warranty of the product. An incorrect and inaccurate use may damage the device and cause damage to the user. Do not use the appliance if it is damaged.

Do not use the appliance to damage objects or to offend people and animals.

Magravs Car Power

Model: 2 - 2016

Input: 12V DC to 48V DV

Output: 12V DC to 48V DV

Maximum loads: 1.950W

Production lot: 2016.2

Producer: Keshe Foundation Manufacturing Italy

