



Installation guide

for Cisco TelePresence MX800 Single Monitor with Single/Dual Camera
on a free standing floor stand or a floor stand secured to the wall

This guide covers the floor stand mounted MX800, in either the free standing or wall secured configurations.



Free standing floor stand



Floor stand secured to the wall

Dimensions

Height: 1818 mm / 71.6 in.

Width: 1596 mm / 62.9 in.

Depth: 156 or 215 mm / 6.2 or 8.5 in. (wall secured)
920 mm / 36.3 in. (free standing)

Weight: 115 kg / 254 lb

Room setup

Explore the Cisco Project Workplace to find inspiration and guidelines when preparing your office or meeting room for video conferencing:

<https://www.cisco.com/go/projectworkplace>

Documentation

Visit one of these websites to find out more about setup, management, and use of this product:

<https://collaborationhelp.cisco.com>

<https://www.cisco.com/go/mx-docs>

Use the first link if your device is registered to the Cisco Webex service and the second link if the device is registered to another service.

Packaging

- 1 Open the plastic snap locks and remove the side walls.

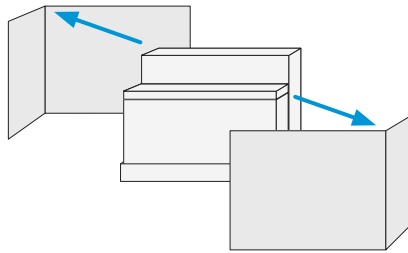

- 2 Lift off box H. Lay box A flat on the floor and remove the lid.

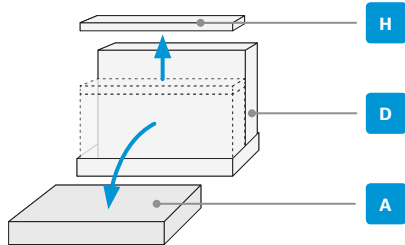

A ... H Boxes are labeled A to H.
This guide refers to the labels.

 **B+E-G** Shows which boxes that are inside.

 Tools and screws are in this box.

Manpower



We recommend four people working together to mount this system. Follow local regulations.

Note that the instructions in this guide also apply to systems with dual camera, even if the illustrations show only the a single camera option.

Screws and tools

The screw kit contains more screws than you need, because the same kit is shipped with all mounting options.

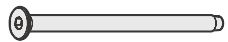

M6x90, countersunk
Tool: Allen key, 4 mm



M6x12, pan
Tool: Allen key, 4 mm



M6x12, countersunk
Tool: Allen key, 4 mm



Allen key, 4 mm

EMC Class A declaration

WARNING: This is a class A product. In a domestic environment this product may cause radio interference in which case the user may be required to take adequate measures.

声明

此为A级产品，在生活环境中，该产品可能会造成无线电干扰。在这种情况下，可能需要用户对其干扰采取切实可行的措施。

1

Remove covers from floor stand



Set aside the covers. They will be replaced when the system is fully assembled and tested (step 8).

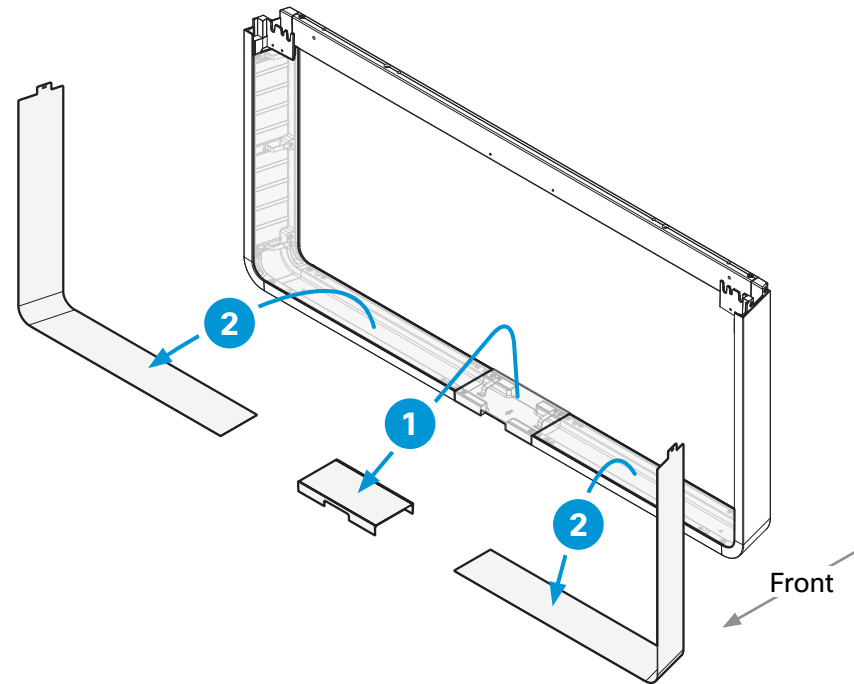

2

Secure floor stand

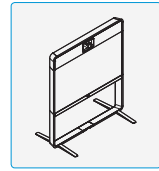

Option A: Mount the feet to the floor stand to allow it to be free standing

Option B (secured to the wall) is described on the next page.

4 ×  M6x35,
countersunk

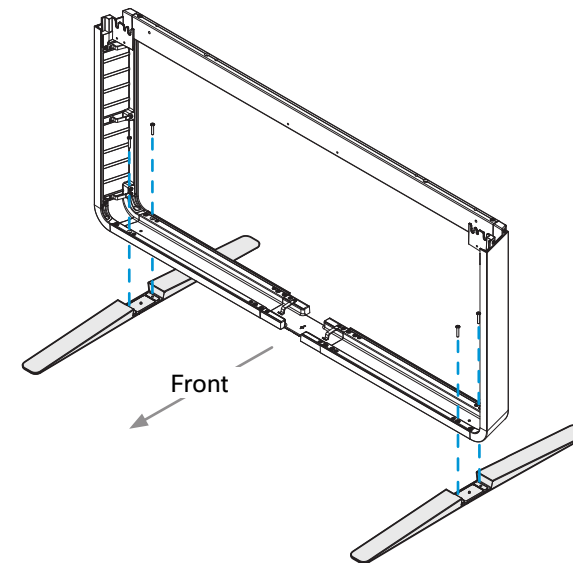

2

Secure floor stand

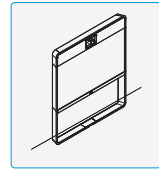

Option B: Use the wall bracket provided to secure the floor stand to the wall

Option A (free standing with feet) is described on the previous page.



The system must be installed by qualified personnel, in accordance with state and local building regulations.

The wall and mounting hardware must be able to safely support the product.

- 1 The wall bracket has two mounting options. Position the bracket the way that suits your room the best.

94 mm / 3.7 in.

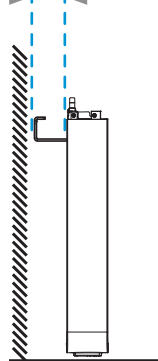

Side view

37 mm / 1.5 in.

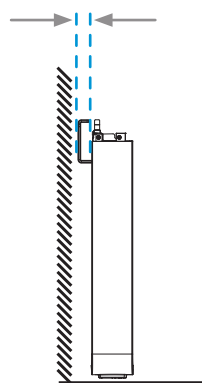

Side view

2



- 2 Place the floor stand in the wall bracket and move the floor stand with the wall bracket into position. Mark the required screw hole positions on the wall.

The wall bracket can be fastened through any of the horizontal slots.

Fasten the bracket in a secure manner ensuring that the wall's structure is sufficient to support the system (screws/mounting hardware not provided; not shown in illustration).

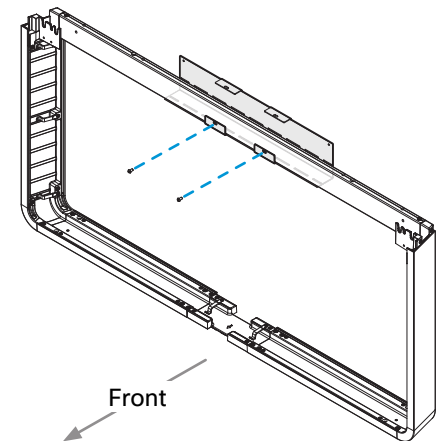

3

- 3 Fasten the floor stand to the wall bracket with the two screws (provided).

2 ×  M6x12, pan

3

Read this before you mount the monitor



The monitor is heavy.

We recommend four people working together to mount the monitor. Two people should lift the monitor using the handles as described below; the other people must help stabilizing the monitor and check that the monitor enters the slots properly.



Use lifting handles

To avoid trapping your fingers, use the lifting handles at the bottom of the monitor.

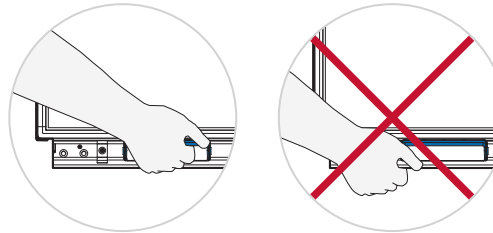

The screws with wing nut, which you can see from the sides of the monitor, must enter the center slot on each side of the floor stand.

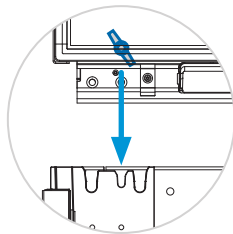

Applies to systems that are secured to the wall:

To assure that the camera(s) can move freely, fasten two bumpers on the rear of the top profile, close to the camera(s).

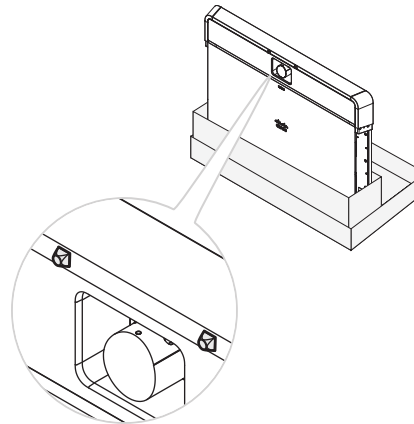

4

Lift monitor onto floor stand



90 kg / 200 lb

- 1 Make sure that the screw with wing nut enters the center slot on both sides.
Do not let go of the monitor before it is securely placed on the floor stand.

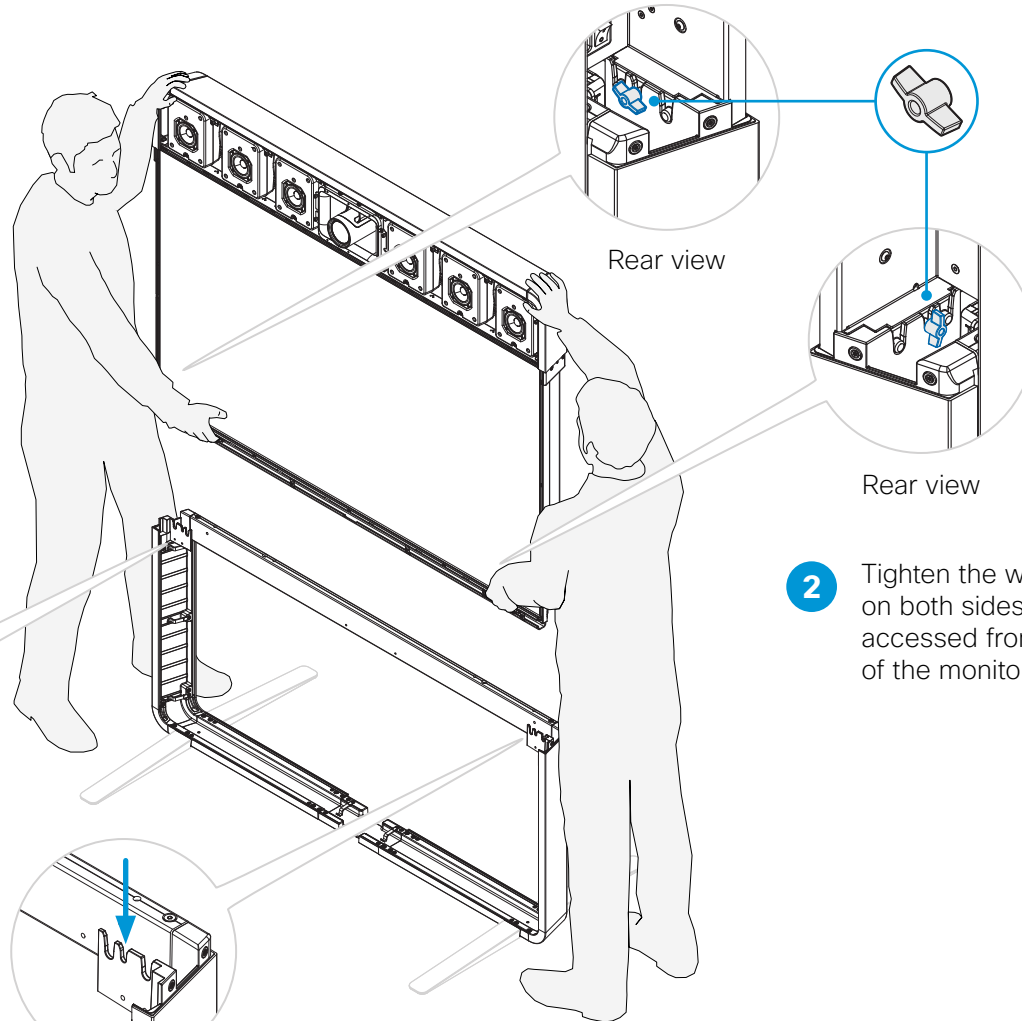
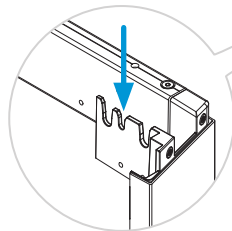
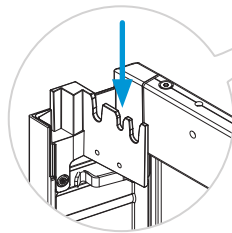

- 2 Tighten the wing nuts on both sides. They are accessed from the sides of the monitor.

5 Fasten monitor to floor stand

4 ×  M6x12,
countersunk

4 ×  M6x90,
countersunk

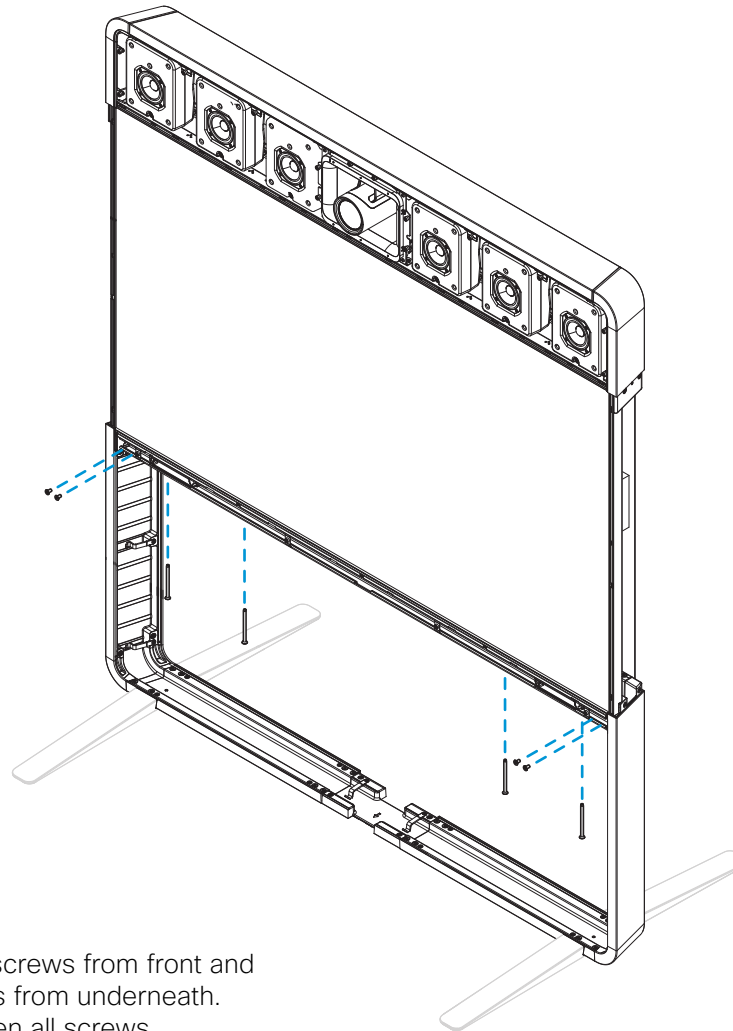

Enter four screws from front and
four screws from underneath.
Then, tighten all screws.

6

Connect cables (page 1 of 2)



Remove any protection foam from the camera(s). Make sure the camera(s) can move freely before connecting power.



Always use the power cables provided.

The plug-socket combination must be accessible at all times, because it serves as the main disconnecting device.

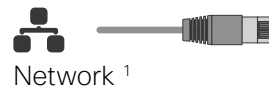
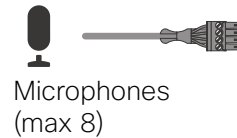

Codec connector panel

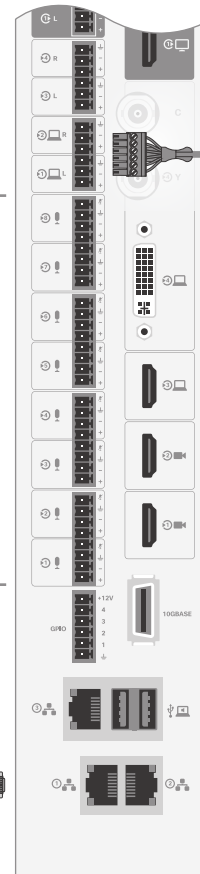

Video input
e.g. computer ²

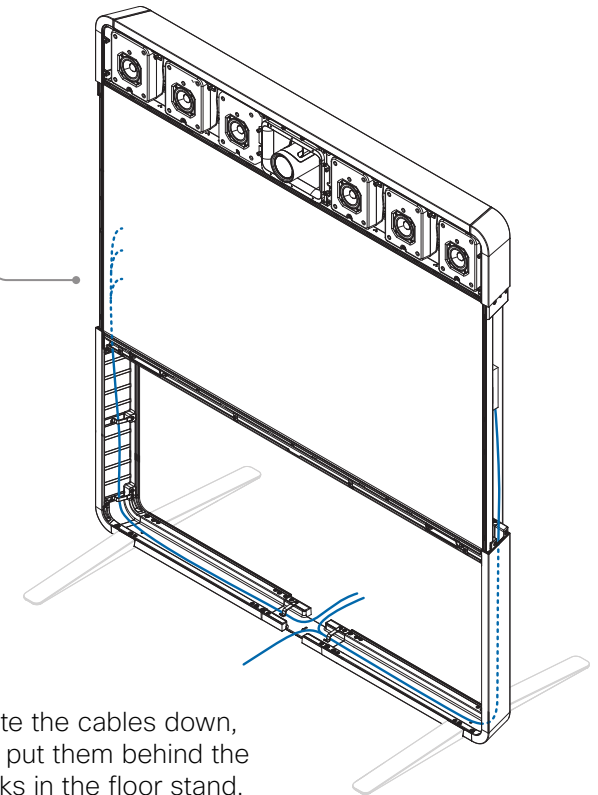

Route the cables down, and put them behind the hooks in the floor stand.

¹ CAT 5e, shielded Ethernet cable, 5 m.

² Two presentation cables are provided: HDMI ↔ HDMI; and DVI/Euroblock ↔ VGA/mini jack.

6

Connect cables (page 2 of 2)

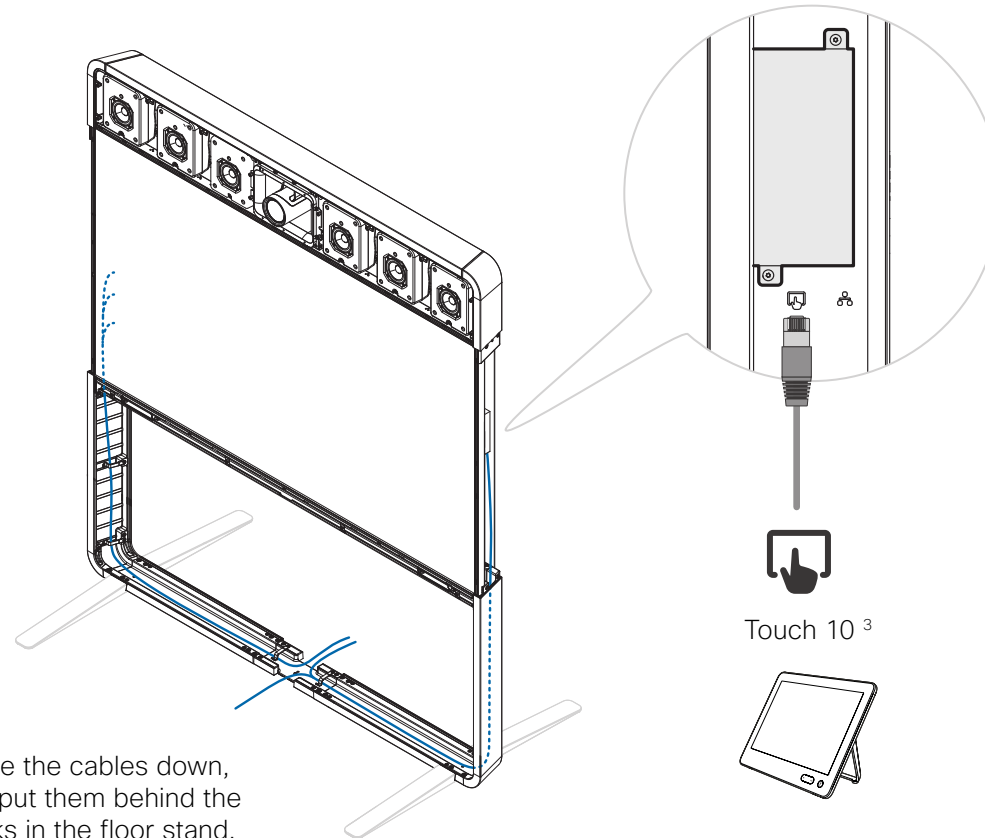

³ The Ethernet socket is behind the lid at the rear of Touch 10. Use one of the provided PoE rated CAT 5e Ethernet cables, 12.5 or 4 m, flat.

7

Start up the system

- Remove the protection foil from the display.
- Make sure the camera(s) can move freely.
- Insert the network and power cables into the wall outlets.
- Switch on the system.

The power switch is located directly below the codec, next to the power connector.

Wait a few minutes while the system starts up. The start-up may include automatic software upgrade and restart of Touch 10 and camera(s).

- Follow the instructions on the Touch controller.

Cisco Webex: To find more information on how to get started, visit <https://collaborationhelp.cisco.com> and look for Getting Started articles for room devices.

Other services: For further information on set-up and configuration, download the Getting Started Guide from the Cisco web site, <https://www.cisco.com/go/mx-docs>

8 Mount covers



The covers snap to magnets.

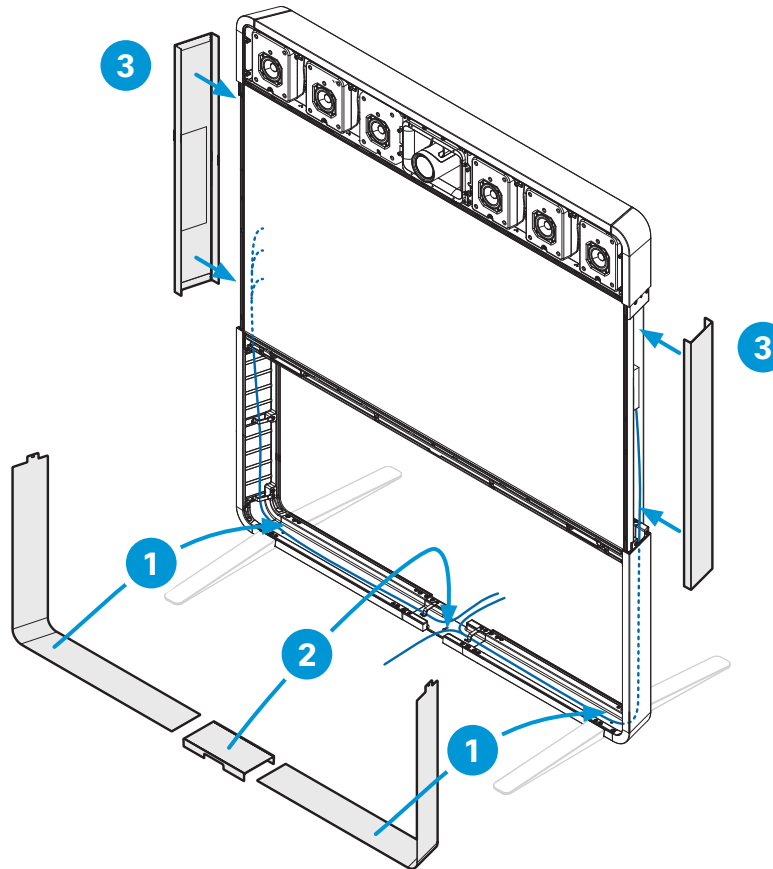

9

Mount textile grilles



Use gloves when handling the textile grille.

The grilles snap to magnets.

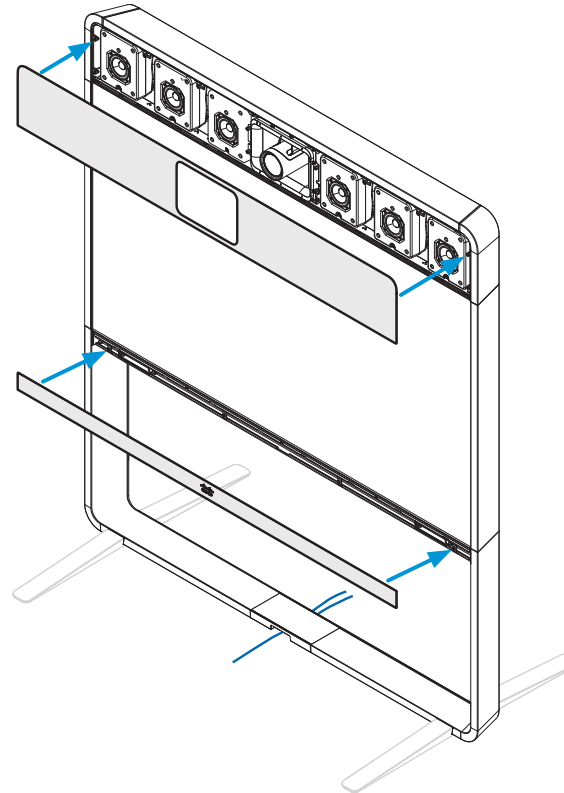

For a list of offices, visit the Cisco website at
<https://www.cisco.com/go/offices>

Cisco and the Cisco logo are trademarks or registered trademarks of Cisco and/or its affiliates in the U.S. and other countries. To view a list of Cisco trademarks, go to this URL: www.cisco.com/go/trademarks. Third-party trademarks mentioned are the property of their respective owners. The use of the word partner does not imply a partnership relationship between Cisco and any other company. (1110R)